

TH-3070-CTL  
TH-3070-CTS  
TH-3070-CTLW  
TH-3070-CTSW

# Installation Instructions

## telehook

Ceiling Tilt Short Mount / Ceiling Tilt Long Mount

### Component Checklist

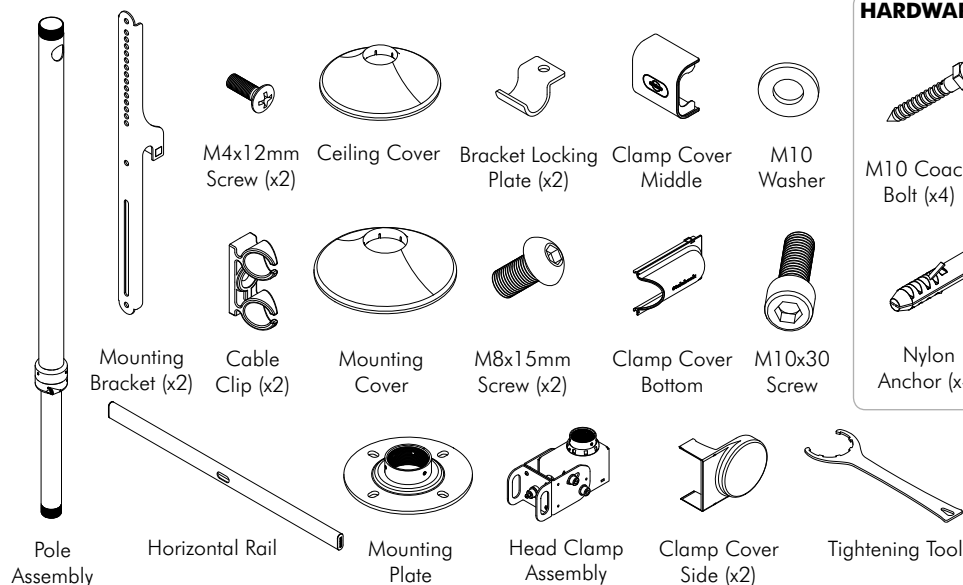

### HARDWARE

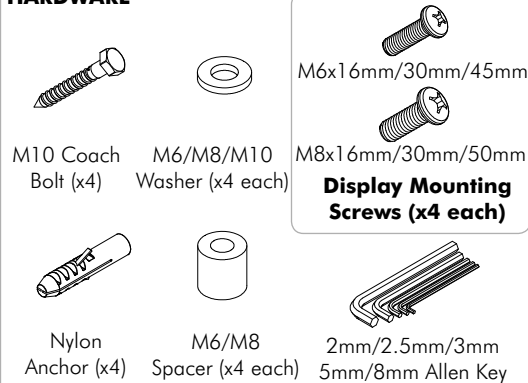

### Tools Required:

- Power Drill
- 7mm(0.25") Drill Bit
- 12mm(0.5") Masonry Drill Bit
- Phillips head screw driver
- 17mm(0.7") Socket Wrench or Shifter

### IMPORTANT INFORMATION:

**! IMPORTANT - Install Telehook Ceiling Mount as per installation instruction.**

! This product supports a maximum load of 65kg (143lbs.).

! This product has a universal mounting hole pattern that suits a broad range of TV's:

From 200-800mm in width and 200-500mm in height.

! The manufacturer accepts no responsibility for incorrect installation.

### Step 1. Check Components

Check you have received against the component checklist and hardware above.

### Step 2. Install Mounting Plate to the ceiling

Using the Mounting Plate as a template, mark and drill 4 holes.

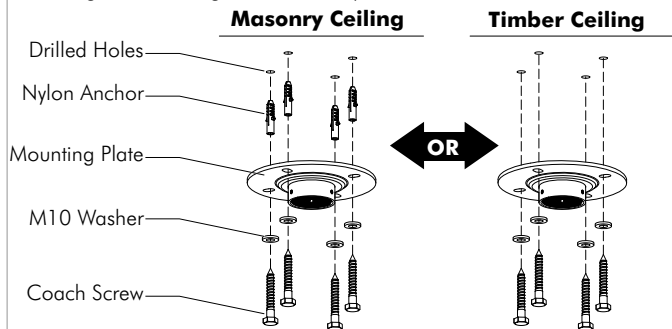

**NOTE:** Drilled hole sizes,  
For Masonry Ceiling, Ø12mm (0.5") and 70mm (2.75") deep.  
For Timber Ceiling, Ø7mm (0.75").

### Step 3. Install Mounting Cover

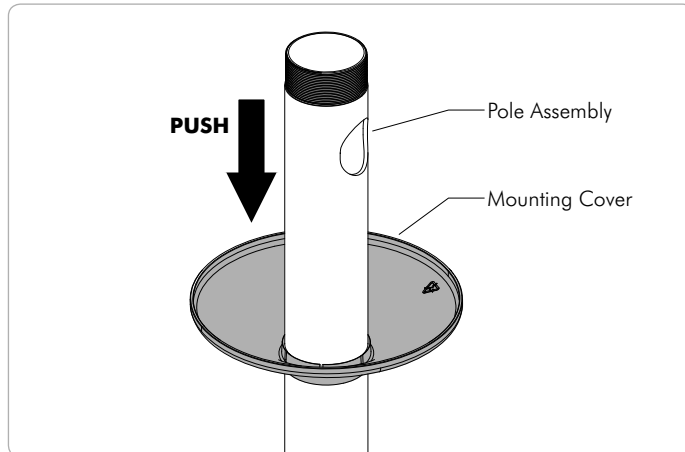

### Step 4. Attach Pole Assembly to Base Plate

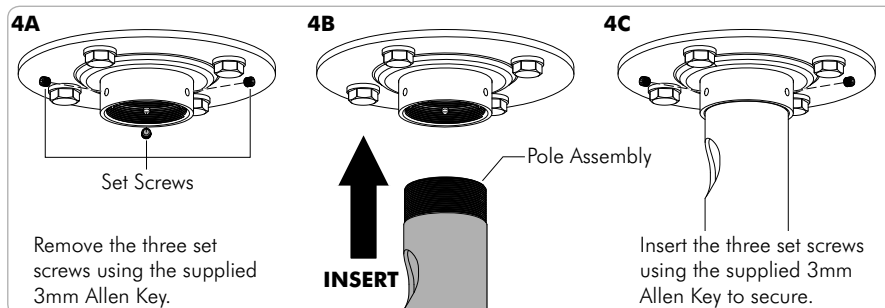

### Step 5. Position Mounting Cover

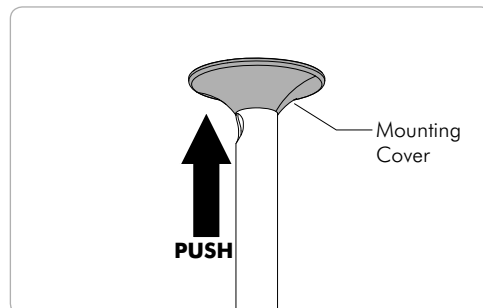

## Step 6. Set the Height of the Pole

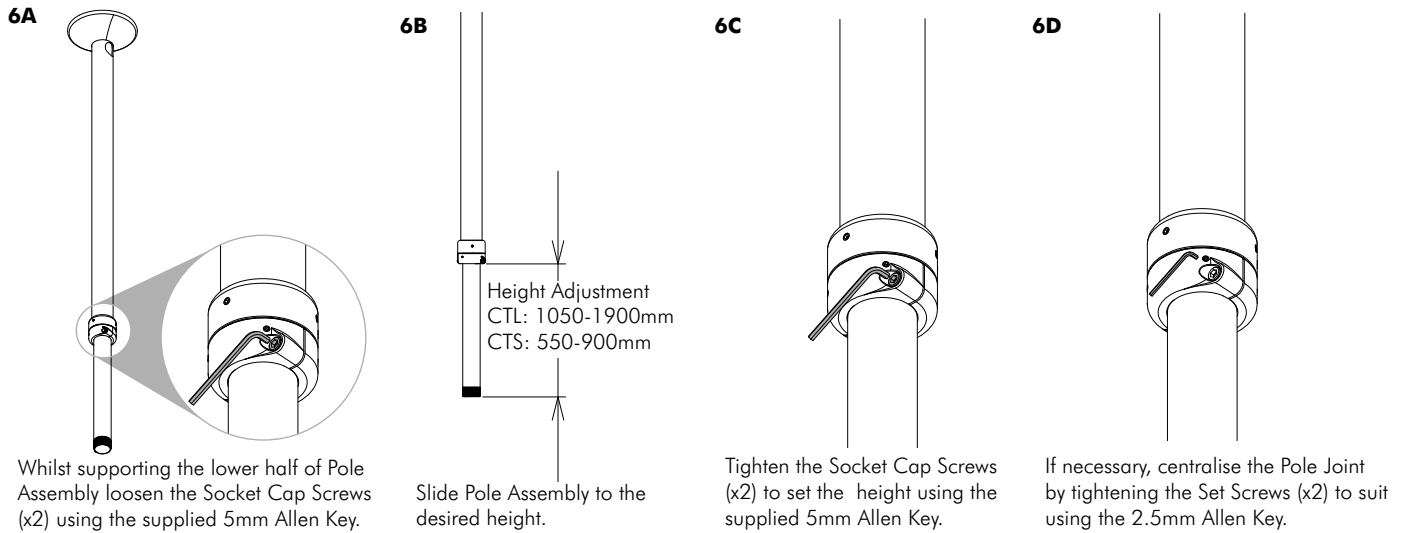

## Step 7. Install the Ceiling Cover

If the lower pole hangs below a suspended ceiling, push the ceiling cover up to the ceiling.

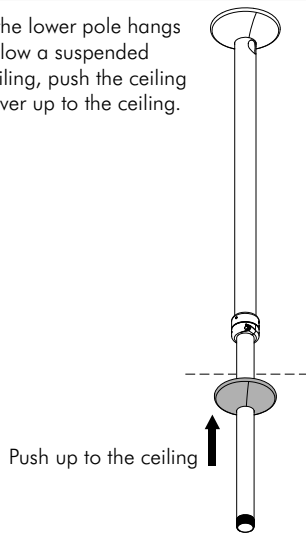

## Step 8. Install the Clamp Head

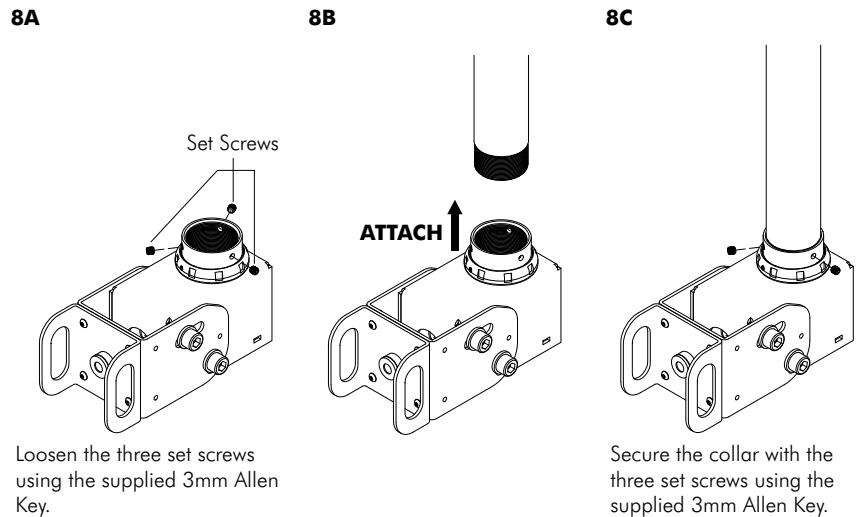

## Step 9. Install the Horizontal Rail

### 9A. To Set Orientation

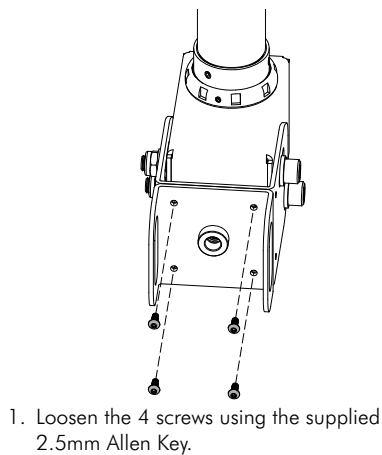

**NOTE:** The rail mount is factory set in the horizontal axis.

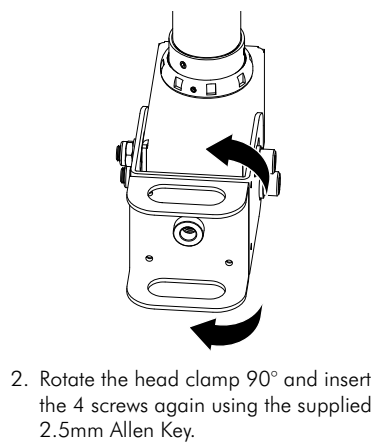

### 9B. Insert Horizontal Rail

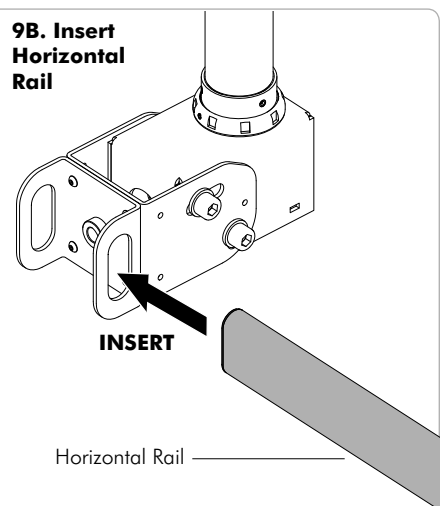

### 9C. Secure Horizontal Rail

1. Make sure the large slot of Horizontal Rail is facing front.
2. Align the holes of the Horizontal Rail and Head Clamp.
3. Lock in place with M10 Screw and Washer using the supplied M8 Allen Key.

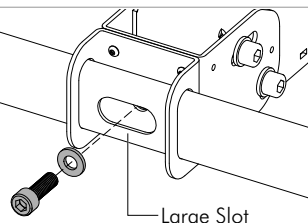

## Step 10. Install the Head Clamp Front Cover

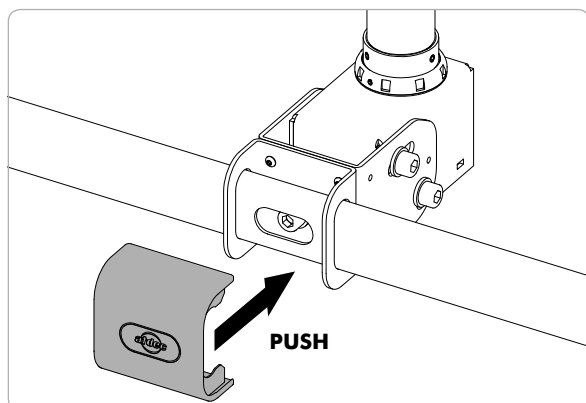

## Step 11. Attach Mounting Brackets to the Display

The mounting brackets support hole configurations from 200-800mm in width to 200-500mm in height.

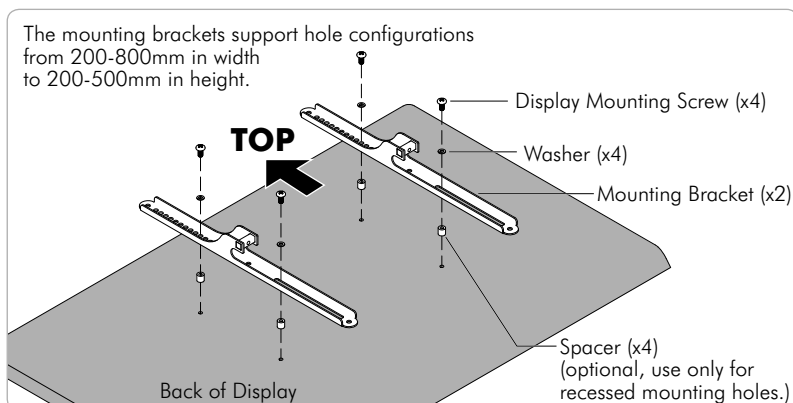

## Step 12. Attach the Display to the Horizontal Rail

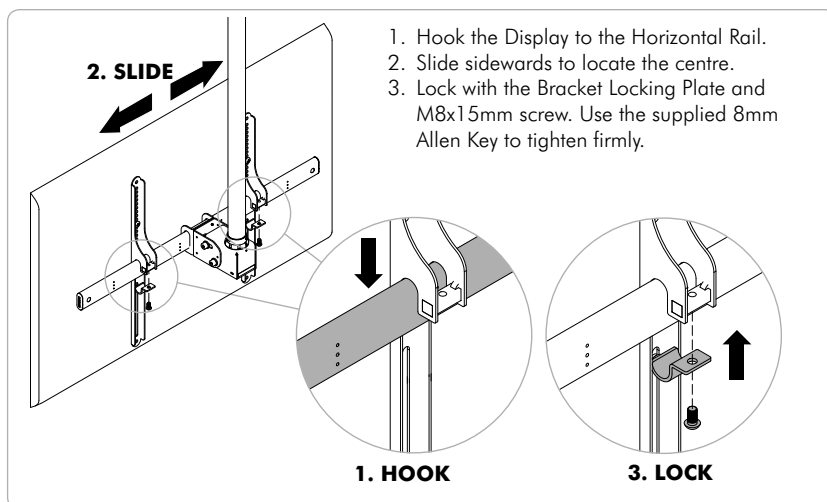

## Step 13. Tilt Adjustment

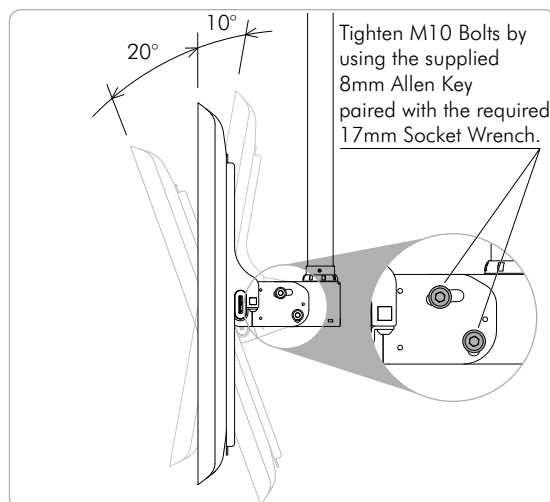

## Step 14. Rotational Adjustment

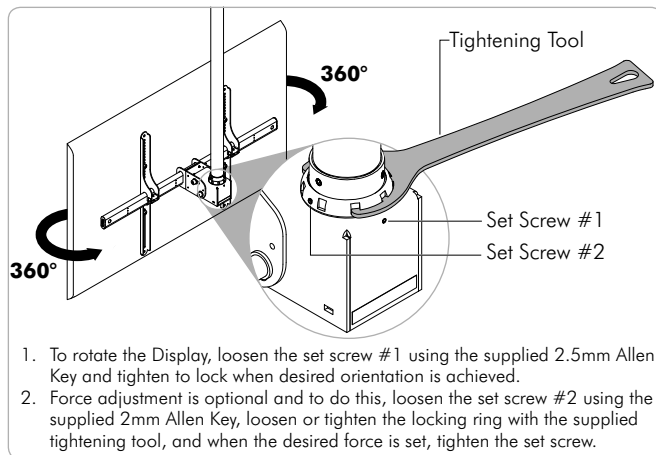

## Step 15. Cable Management

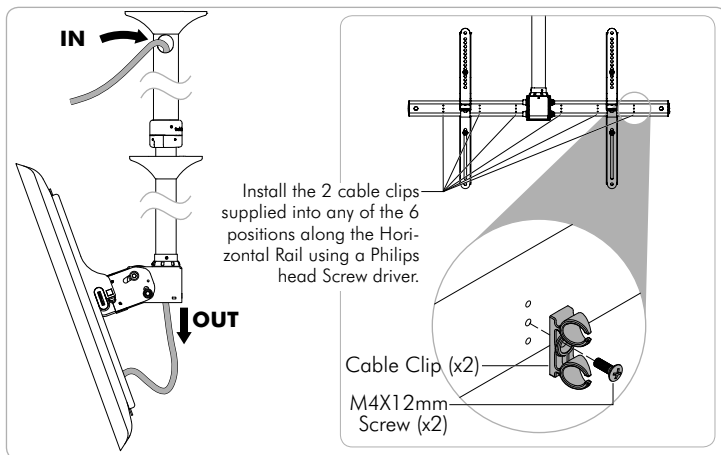

## Step 16. Put on Clamp Covers

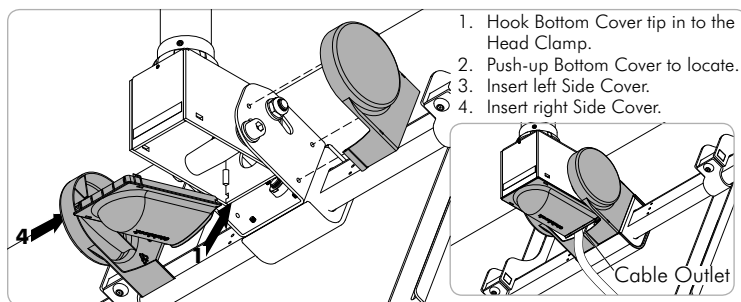

## Step 17. Store Supplied Allen Keys

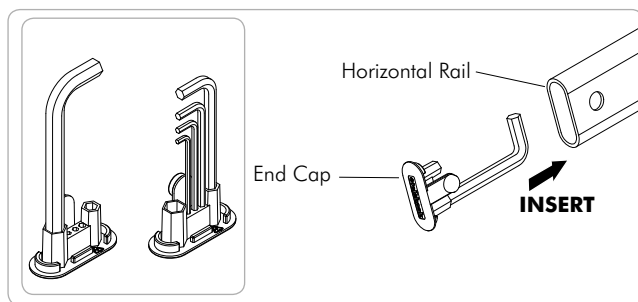

## Installation Complete



No portion of this document or any artwork contained herein should be reproduced in any way without the express written consent of Atdec Pty Ltd. Due to continuing product development, the manufacturer reserves the right to alter specifications without notice. Published 02.06.14 ©